

FACE AVANT IDS1/PEP34

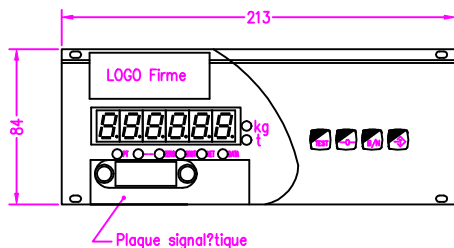

FACE AVANT IDS2/PEP36

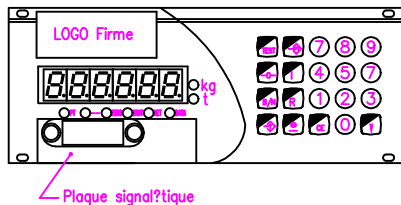

FACE ARRIERE IDS1-2/PEP34-36

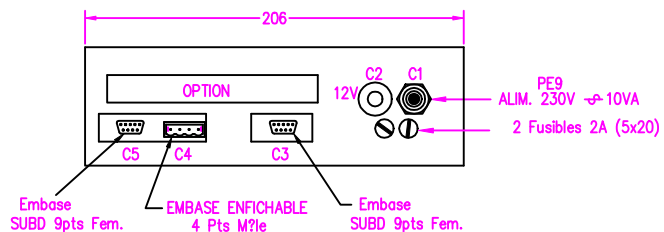

RACCORDEMENT

| N° de Broches | Rep Sres Prises |            | C1    |         | C2                   |         | C3 |  | C4 | C5 |
|---------------|-----------------|------------|-------|---------|----------------------|---------|----|--|----|----|
|               | ALIM.           | Opt. BATT. | RS232 | Minitel | BdC pas.             | Capteur |    |  |    |    |
| 1             | 230V            |            | ≡     | ≡       | R-                   | ≡       |    |  |    |    |
| 2             | ≡               | +9V        | RxD   | TxD     | R+                   | 0V      |    |  |    |    |
| 3             | 230V            | +12V       | TxD   |         | T- } RS485<br>2 fils | A-      |    |  |    |    |
| 4             |                 |            |       | RxD     | T+ }                 | M-      |    |  |    |    |
| 5             |                 |            |       |         |                      | A+      |    |  |    |    |
| 6             |                 |            | DTR   | 0V      |                      | M+      |    |  |    |    |
| 7             |                 |            | 0V    |         |                      |         | R- |  |    |    |
| 8             |                 |            |       |         |                      | R+      |    |  |    |    |
| 9             |                 |            |       |         |                      | NC      |    |  |    |    |

Vue de PROFIL

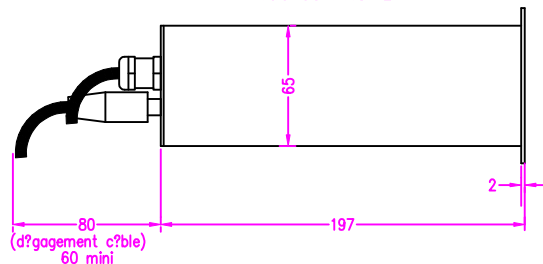

DECOUPE PANNEAU / MONTAGE ENCASTRE avec cadre d'encastrement n?100299 (Dim: 244x104x11)

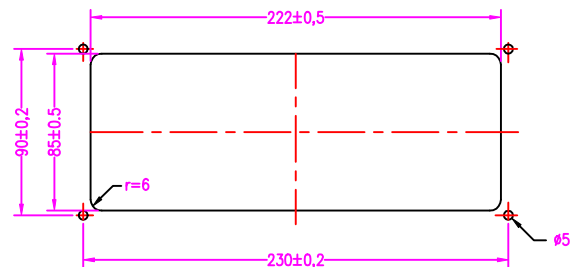

- PRESENTATION : — Coffret t?le zingu?e  
 — Etanch?it? : IP44  
 — Poids : 2,2kg  
 Livr? avec cordon d'alimentation 230V  
 —Possibilit? de montage :  
 encastr?  
 en coffret de table  
 en rack 19" 2U

ENCOMBREMENT DU COFFRET DE TABLE

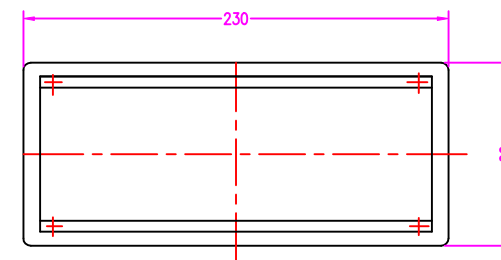

EMBASE ENFICHABLE 4pts m?le

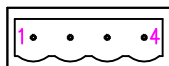

EMBASE SUBD 9pts Fem.

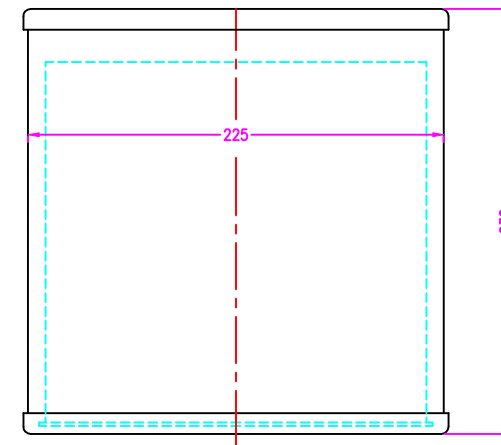
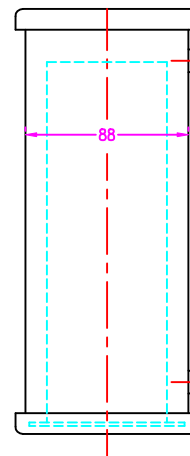
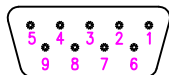

CE PLAN EST NOTRE PROPRIETE : IL NE PEUT ETRE REPRODUIT OU COMMUNIQUE SANS NOTRE AUTORISATION ECRITE



ENCOMBREMENT & RACCORDEMENT  
 INDICATEUR IDS1-2/PEP34-36

Dess. par: G.P le: 10/10/94

Ech: 1/4 Folio: 2/.

N? 101886/1A